

4 Technical data

Rated data

Rated data

Electrical data				
	R_B	P_d	Q_B	U_{max}
	[Ω]	[W]	[kWs]	[V _{DC}]
ERBM020R150W	20	150	13	800
ERBM039R120W	39	120	6	
ERBM100R100W	100	100	15	400
ERBM180R050W	180	50	7.5	
ERBM390R100W	390	100	15	800

R_B	Resistance
P_d	Permanent power
Q_B	Heat quantity
U_{max}	Max. operating voltage

Temperatures			
	T_{nom}	T_{TK}	T_{max}
	[°C]		
On the surface	200	300	500
On the clearance edge *)	90	100	120

T_{nom}	Maximum temperature for rated data
T_{TK}	Temperature at which the thermal contact is activated
T_{max}	Maximum temperature in the case of improper use
*)	Measured for air as the ambient medium (small coefficient of thermal conductivity); if materials which heat up are located at the clearance edge (greater coefficient of thermal conductivity), the temperature continues to rise.

kabea GmbH (Innovative Antriebe)
 Koßmannstraße 47, D-66538 Neunkirchen
 Telefon:+49 (0)6821/919238, Fax:+49 (0)6821/919239
<https://www.becker-antriebstechnik.org/>

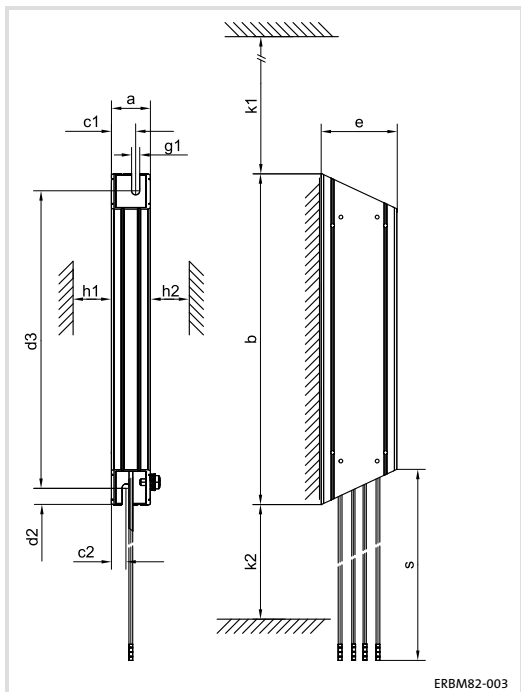
Mechanical data

ERBM82-003

	a	b*	c1	c2	d2	d3*	e
	[mm]						
ERBM020R150W		337				317	60
ERBM039R120W		267				247	
ERBM100R100W	20.6	235	12.8	7.9	7.5	220	40
ERBM180R050W		175				160	
ERBM390R100W		235				220	

	g1	h1	h2	k1	k2	s**	
	[mm]						[kg]
ERBM020R150W						700	1.10
ERBM039R120W							0.91
ERBM100R100W	4.3	>30	>30	>200	>100	500	0.37
ERBM180R050W							0.28
ERBM390R100W							0.37

 * Tolerance ± 1 mm

** Tolerance +30mm

kabea GmbH (Innovative Antriebe)
 Koßmannstraße 47, D-66538 Neunkirchen
 Telefon:+49 (0)6821/919238, Fax:+49 (0)6821/919239
<https://www.becker-antriebstechnik.org/>